

- NOTES:
 1. PACKAGING FOR SERVICE:
 A. ASSEMBLE ITEMS BEFORE PACKAGING
 B. PACKAGE ITEMS IN SUCH A MANNER THAT THEY WILL NOT BECOME DAMAGED DURING SHIPPING
 C. PACKAGE KIT IN A PLASTIC BAG WITH CORE H&F PART NUMBER, DESCRIPTION, REVISION, PO#; ONE KIT PER BAG
 D. LABEL PACKAGE TO INCLUDE:
 i. PO# AND DATE
 ii. ASSEMBLY NUMBER
 iii. BAR CORE OF ASSEMBLY NUMBER (CODE 128)
 iv. ASSEMBLY DESCRIPTION
 v. ASSEMBLY REVISION
 vi. WEIGHT (LBS/Kg)

REVISION HISTORY				
REV	DATE	DESCRIPTION	ECO	BY
A	11/17/2015	PRODUCTION RELEASE	15185	MMG

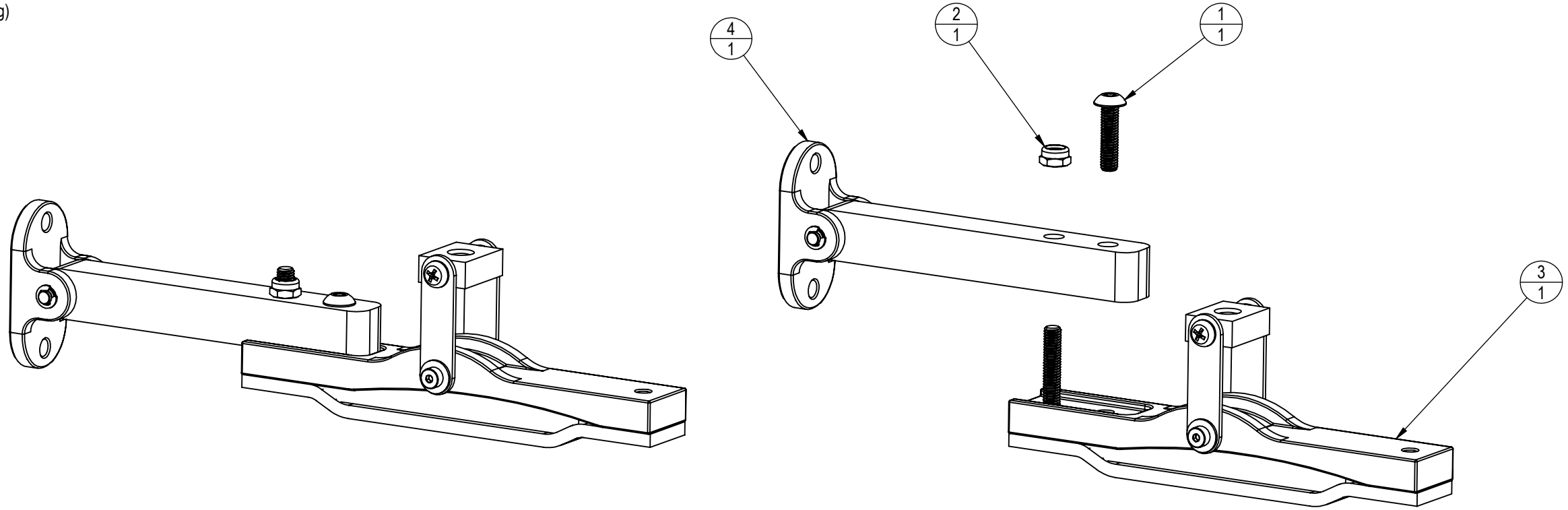

ITEM NO.	PART NUMBER	DESCRIPTION	QTY.
1	110-3634	SCREW, M5X0.8X20 BHSC SS HE	1
2	731-1957	NUT, M5, NYLOCK	1
3	740-8945	ASSY, BRAKE PAD LINK, ST BIKES	1
4	740-8946	MOUNT, BRAKE LINK, S5/S7	1

DOCUMENT STATUS:

APPROVED
 By Kevin Young at 8:15 am, Dec 11, 2015

NOTICE OF PROPRIETARY INFORMATION

THIS DOCUMENT SHALL NOT BE REPRODUCED NOR SHALL THE INFORMATION CONTAINED HEREIN BE USED BY OR DISCLOSED TO OTHER EXCEPT AS EXPRESSLY AUTHORIZED BY CORE HEALTH & FITNESS, LLC.

CLASS OF WORK	UNLESS OTHERWISE SPECIFIED DIMS ARE IN mm. TOLERANCES FOR MEASURE OF LENGTH ARE:							ANGLES = ±2°
	0.5 to 3	> 3 to 6	> 6 to 30	> 30 to 120	> 120 to 400	> 400 to 1000	> 1000 to 2000	
FINE	±0.05	±0.05	±0.1	±0.15	±0.2	±0.3	±0.5	----
MEDIUM	±0.1	±0.1	±0.2	±0.3	±0.5	±0.8	±1.2	±2
COARSE	±0.2	±0.3	±0.5	±0.8	±1.2	±2	±3	±4
VERY COARSE	----	±0.5	±1	±1.5	±2.5	±4	±6	±8

MATERIAL SEE BOM

FINISH N/A

VENDOR: N/A

P/N: N/A

THIRD ANGLE PROJECTION



DRAWN	INITIAL	DATE
CHECKED	MMG	11/17/15
APPROVED		
	U.O.M.	MM

CORE HEALTH & FITNESS, LLC
 4400 NE 77th Ave., Suite 300
 Vancouver, WA 98662

CORE PART NO **740-8944** REV **A**

TITLE **ASSY, BRAKE, S5/S7**

SCALE: 2:3 | SHEET 1 OF 1 | SHEET SIZE: B